

CONCEPT DEVELOPMENT

*Character Typologies*

**Woodland Glade**

- > Opportunities for pockets of soft open space within existing tree belts.
- > Retention of existing mature trees and thickets surrounding woodland meadows.
- > Inclusion of variety of wildflower planting in order to create attractive lawns and boundaries to the glades.

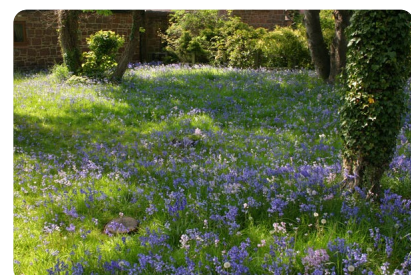
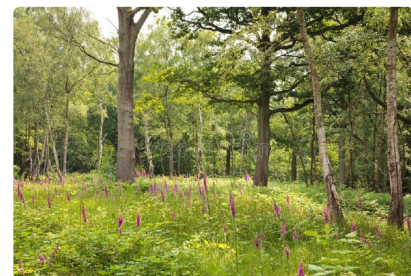
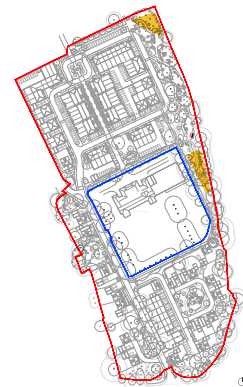

**Green Connectors**

- > High quality hard landscaping integrated with soft planting.
- > Introduce sustainable drainage where possible including permeable paving.
- > Provide comfortable and attractive threshold between vehicular access points and pedestrian spaces.

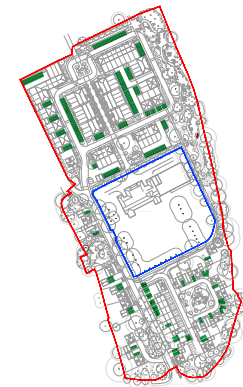



CONCEPT DEVELOPMENT

*Site Masterplan*

The landscape masterplan opposite shows the intention for the development to be as green and verdant as possible. Retaining as much of the existing green infrastructure is paramount and where possible maximising new tree and soft planting within the landscape. This will be achieved through new tree lined streets, pocket green spaces and a variety of SUDS elements.

A series of playable trails and informal play nodes will be embedded throughout the landscape to give the development a playful character and to cater for children of all ages and abilities.

Key movement and access corridors have been developed to ensure easy cross site legibility and to connect the Aerodrome with Salmons Lane West to the south.



- 1 Woodland 'Play on the way'
- 2 Rain gardens
- 3 Residential avenue
- 4 Communal green pocket with open lawn spaces
- 5 Forest play pocket
- 6 Forest walking trail
- 7 Wildflower glade
- 8 Ecological route
- 9 Historic flag pole



CONCEPT DEVELOPMENT

*Detailed Area - Imaginative Woodland Zone*

The development of the eastern boundary area is a key component of the landscape scheme. The intention is to retain the woodland character but to integrate playable trails and play nodes below the canopy and to develop it as an imaginative woodland play zone that connects the Aerodrome and the southern residences in a playful way.

Naturalistic play elements will align with the woodland look and feel. and play nodes will be implemented as part of a play trail running the length of the space connecting northward towards the Aerodrome.

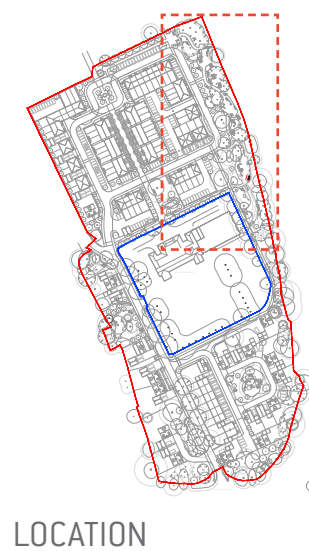

LOCATION



*Indicative play palette*

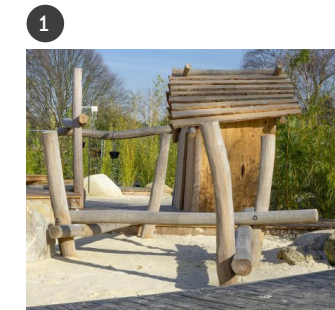

BALANCE BEAMS

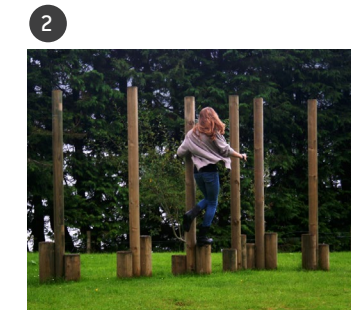

STEPPING STILTS

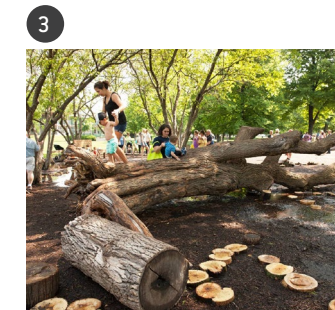

NATURAL TREE TRUNKS



TUNNEL NET

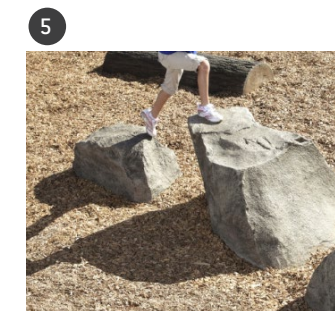

BOULDERS

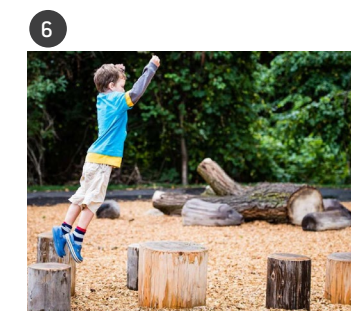

STEPPING LOGS

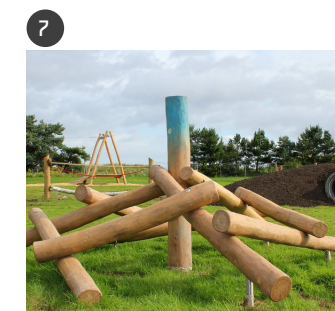

TRUNK PILE



CLIMBING FRAME